

GPS LED HEAD-UP DISPLAY

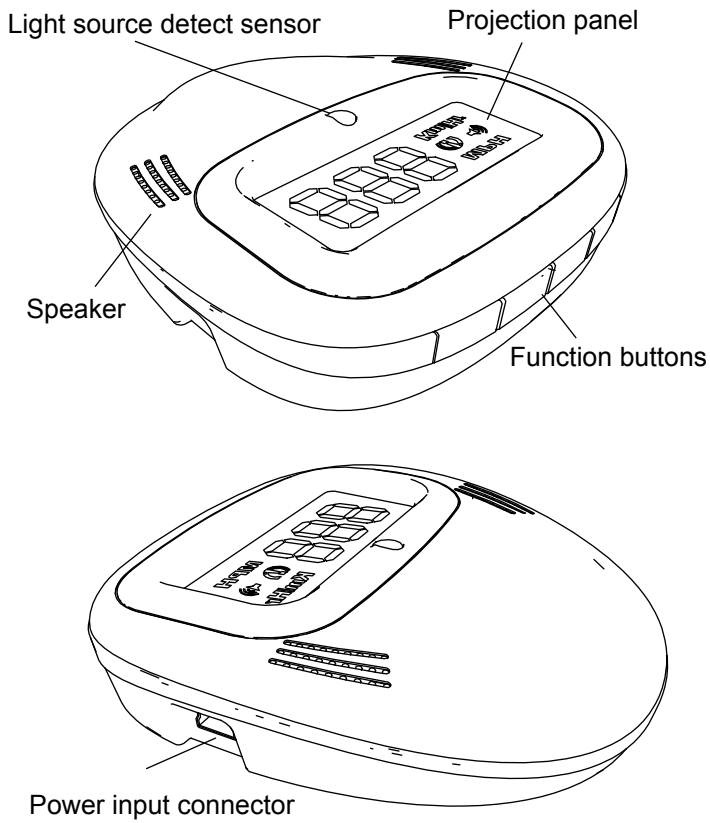

Functions

1. Vehicle speed display.
2. Speeding Warning.
3. GPS HUD can be wirelessly connected to mobile devices such as PDA or Laptop computer through Bluetooth.
4. GPS HUD also serves as a navigational satellite receiver.

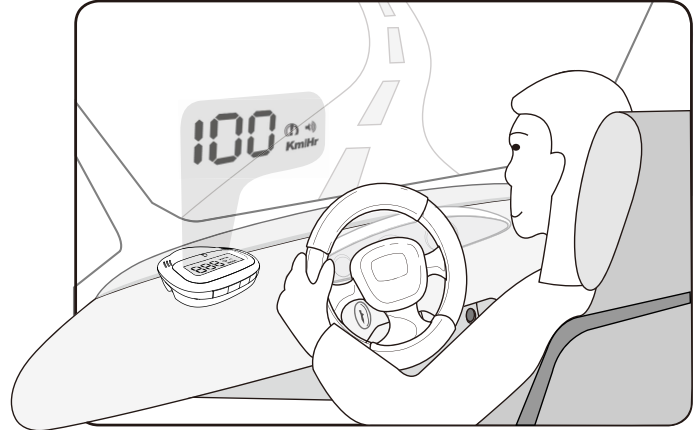

Package contents

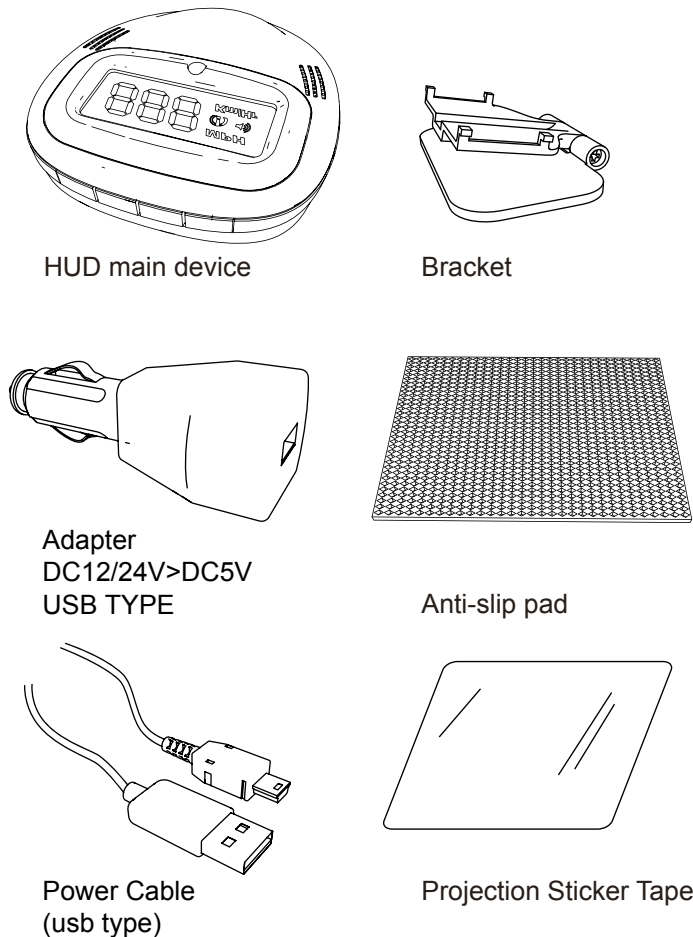

Installation

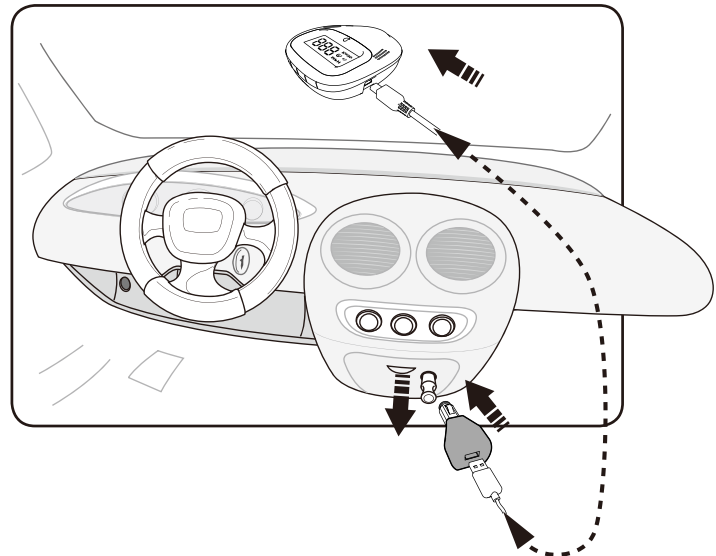

1. Connect the power cable with the plug.
2. Connect the power cable with GPS HUD on the mini USB end.
3. Plug the power cable into the cigarette lighter socket of the car.
4. Once the power is on (or when the car starts), GPS HUD will begin searching for the satellite signal. The projection will show as follows:



- Fix the position of GPS HUD on the dashboard for best viewing angle.
- Place the GPS HUD on the anti-slip pad or the adjustable bracket.

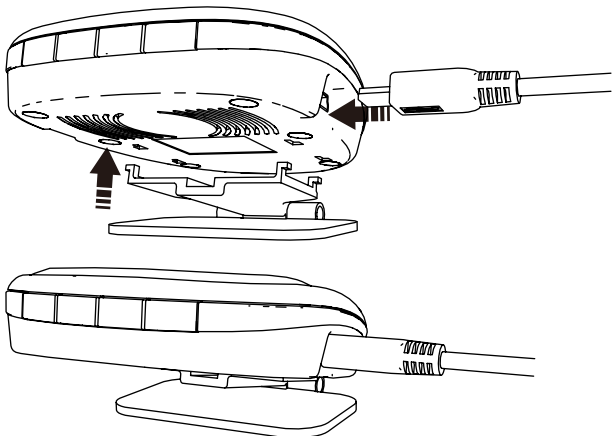

- Stick the reflecting film on the windshield where the GPS HUD projects its image.

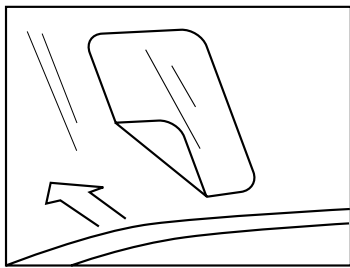

Stick the reflecting film on the windshield where the GPS HUD projects its image.

Screen functions

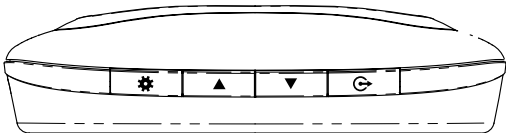

- Press this button to enter the setting mode, press ▲▼ button to switch Km/hr or MPH mode.
- There are 5 ranges of speeding value from 50, 70, 90, 100, 110 installed. Press ▲ will show 50~70~90~100~110 in turn, press ▼ will show 110~100~90~70~50. For example, if the projection panel shows “70” after select, it means the speeding value is 70.
- Press button to turn on/off the speeding alarm sound.

888 MPH
KmHr

MPH MPH mode

KmHr Km/Hr mode

Speeding warning sound

Speeding warning sign(Red)

Displayed speed value adjustment

Press * button twice to enter the setting mode of speed value fine adjustment.

This function mode is used for adjusting the displayed speed value to agree with that of the original dashboard. If the reading from the HUD is higher, press ▼ button to reduce the value; if the reading is lower, press ▲ button to increase the value.

Press the ← button will leave setting mode, press the * button will go to next setting mode.



Speeding Value Setting

There are 5 ranges of speeding value from 50, 70, 90, 100, 110 installed.

Press ▲ will show 50~70~90~100~110 in turn, press ▼ will show 110~100~90~70~50.

When the projection panel shows “70” after select, it means the speeding value is 70.

Press * button 3 times to set first set of speeding value.

For example, if need to adjust the speeding value to 60, enter the first speed value “50”, then press ▲ button until “60”.

Press the * button once will go to next set of speeding value.

60 **KmHr**

Basic Specification	
Head Up Display	
Operating Voltage	DC5V±5%
Adapter power in	DC12~24V
Power Consumption	450 mA
Operating Temperature	-20 C~85 C
HUD Dimensions	100.7mm X 91.4mm X 26.5mm
HUD Weight	90.5g
Speed Ranges	0~255Km/Hr
Max. Brightness	5500 nit
Display of driving speed	green
Speeding icon	red
Music icon	orange
MPH, Km/Hr icon	green
GPS Module	
GPS Chipset	SiRF Star III
Frequency	1575.42MHz (L1 band, CA code)
Channels	20-channel
Accuracy	2DRMS: approx. 10m
TTFF (Refer to SiRF Star chip specification)	Cold start: 42s Warm start: 38s Hot start: 1s